



SERIOUS DATA SECURITY.
REAL SERIOUS.

SEAL-AP
ARMORED PADLOCK WITH
DIGITAL KEY ACCESS CONTROL

The Armored Padlock is an IP 66 rated smart padlock that eliminates keys and combinations to efficiently secure and manage data cabinets and wall mounts in indoor and outdoor locations. When in close proximity to the padlock, authenticated users can open it with a proprietary mobile app and digital key. The padlock functions as a stand-alone security device and is able to withstand abuse and resist attempts at theft and vandalism.

Efficient and fast setup and maintenance.
No physical keys. No combinations.



SECURITY FEATURES

- **Enhanced Audit Trails-** Generate reports that detail the authorized and unauthorized access attempts
- **Administrator Role-** Invite and create users, issue keys and expiry dates, delete users and keys, and more
- **Authenticated Users-** Users receive digital keys on their smartphone; phones respond to key creation and cancellation in real time
- **Eliminate Physical Keys-** Digital keys use unique Bluetooth technology to unlock handles when user phone is at short-range proximity
- **Integrated to Systems-** Seamlessly integrates with existing monitoring and ticketing platforms
- **Unlimited Scalability-** Infinite creation of digital keys and authenticated users; no limit to the number of controlled cabinets, wall mounts, etc.
- **Off-network Technology-** Cloud management creates a cyber-resilient solution; eliminates physical and virtual servers, physical network connections, and IP addresses
- **Digital Security-** Unique and patented security architecture, TLS 1.3, ECC 192 bit

CONSOLIDATE AND MANAGE

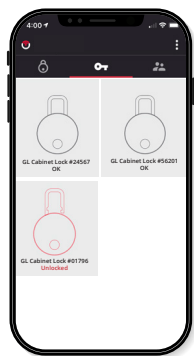

Armored padlock for use with hasp lock swing handles

ES, E, & Colo Cabinets

WMCM, WDX, WLP Wall Mounts

Use any smartphone or any Bluetooth-enabled device with the proprietary app

- Send digital keys to authenticated users
- User phone responds to key creation and cancellation in real time
- Open locks when user phone is at short-range proximity

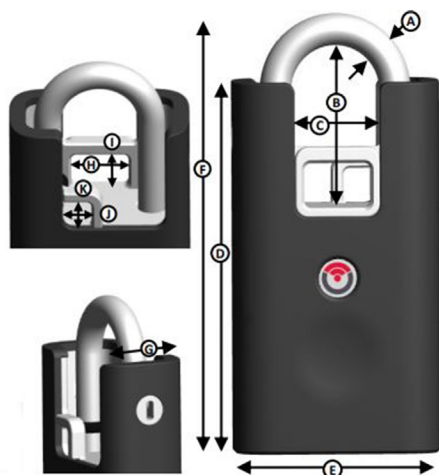

PHYSICAL FEATURES

- Silicone rubber shell
- Replaceable extreme weather battery
- Status indicator light
- Micro USB port - backup power
- Open/Close integrated sensors
- Optional failsafe unlock
- Tether options: Kensington lock slots, Two chain loops

PARAMETER	Certification / Characteristic
Water Resistance Rating	IP66; do not submerge
Replaceable Battery	ER18505 Lithium (3.6V, 4000mAh)
Shackle Metal	Boron steel; hardness: ASTM E18-17, coating: ASTM B689
Case Metal	Chrome-plated Zamak alloy
Weight	700 grams
Materials Composition	REACH and RoHS-compliant
Certifications	ANATEL, IFETEL, IP66, EN 62262 (IK10)
RF Connectivity	Bluetooth, 2.402 - 2.480 GHz
Impact Resistance	EN 62262-IK10, drop survival: 2 meters
Shim Resistance	ASTM F8330-13
Operating Temperature	-30°C to 70°C
Max. Temp.	-55°C to 110°C

DIMENSION	A	B	C	D	E	F	G	H	I	J	K
SIZE (mm)	10	50	25	109	60	135	29	21	14	10	11

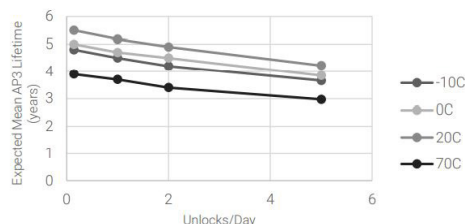

EXPECTED MEAN BATTERY LIFE

Actual battery life may vary based on the environment, frequency of use, and long-term temperature conditions. Individual battery performance will vary based on production characteristics. Individual battery lifetime is not guaranteed.